

8" Two Way Wall Mount Speaker(5W/10W/20W/40W/80W)

WS-80T



FEATURE:

- Built-in 70V & 100V transformer
- 8"+2" two-way wall mount speaker
- Economy range speaker of excellent sound quality
- Power taps 5W/10W/20W/40W/80W @100V output
- Both 100V and 80hm outputs selector
- 360degree rotatable mounting bracket is supplied
- Metal grille, ABS body and metal bracket
- Fashion speaker of black color

DESCRIPTION:

HEINRICH all speakers support EASE, CATT, ULYSSES models for acoustic studies. This means the acoustic model can be designed to simulate the sound quality and distribution prior to installation All HEINRICH loudspeaker have undergone trough testing procedure to ensure that all products compliance with LOW VOLTAGE DIRECTIVE (BS EN 60065, 2003) and EMC (BS EN 61000-6-Part 1/2/3/4).

The WS-80T is a wall mount speaker built-in 70V/100V transformer. This technique reduces line losses on longer distance and allows easy parallel connection of multiple loudspeakers. The built-in 8"+2" two ways speaker driver is designed of wide frequency response 100-18kHz. The multiple power taps 5W/10W/20W/40W/80W are helpful for different applications varies from room size and ambient noise surroundings. The metal grille, ABS enclosure and stainless mounting bracket are of black color. Easy & secure wall mount installation through the supplied mounting kit. It is an ideal choice for industrial and commercial applications in hotel, school, office and factory where background music and paging is needed.

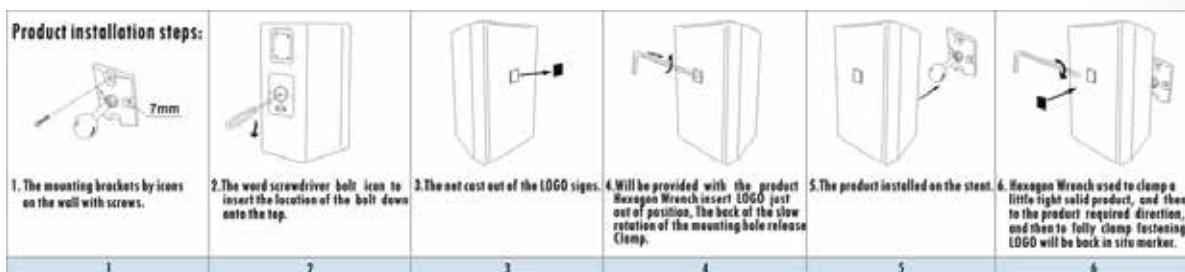

As per our company policy one of the constant Product improvement the right is there for reserved to modify product specifications without prior notice

8" Two Way Wall Mount Speaker(5W/10W/20W/40W/80W)

SPECIFICATION:

Model	WS-80T
Power Taps @100V	5W/10W/20W/40W/80W
Power Taps @70V	2.5W/5W/10W/20W/40W
Impedance	Balck: Com Red 2K Ω /1K Ω /500 Ω /250 Ω /125 Ω /8 Ω
SPL(1W/1M)	94dB
Max. SPL (Rated W/1M)	113dB
Frequency Response (-10dB)	50-20KHz
Finish	Baffle: ABS Black/White
	Grille : Steel, Black/White
Speaker Driver	8"x1-2"x1
Dimensions	280x225 x 375mm
Weight	6.2Kg
Mounting	With mounting bracket fixed by screw

Direction Diagram:

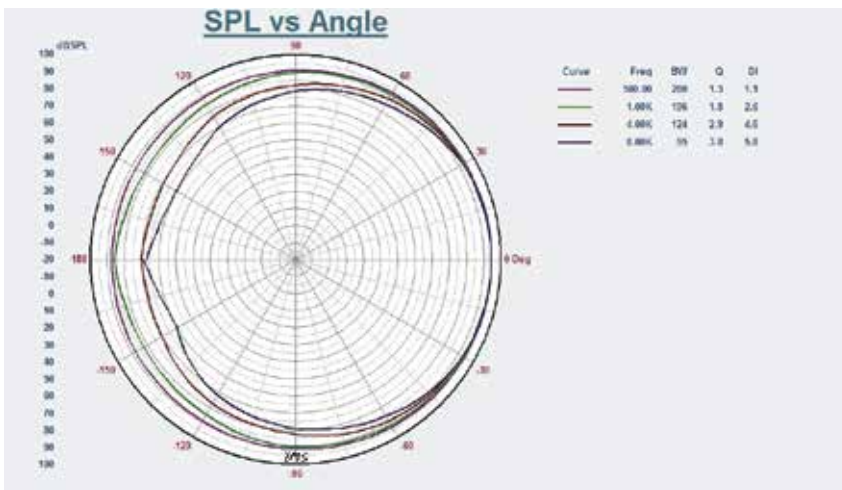

Frequency Response:



As per our company policy one of the constant Product improvement the right is there for reserved to modify product specifications without prior notice